

de Montageanleitung
en Mounting instructions
fr Instructions de montage
sv Monteringsinstruktion
nl Montage-aanwijzing
it Istruzioni di montaggio
fi Asennusohje
es Instrucciones de montaje
da Monteringsvejledning

Drehantrieb
Rotary-type actuator
Servo-moteur à action angulaire
Spjällställdon med vridande rörelse
Luchtklepservomotor voor rot. aandrijving
Servocomando rotativo per serrande
Kiertoliikkeinen ilmapeltien toimimoottori
Actuador de acción rotativa
Motor for drejebvægelse

GLB..9E..

A **de** Lieferumfang
en Deliverables
fr Contenu
sv Leverans

nl Leveringsomvang
it Contenuto
fi Toimituslaajuus
es Contenido

da Leverancens omfang
zh 设备构件

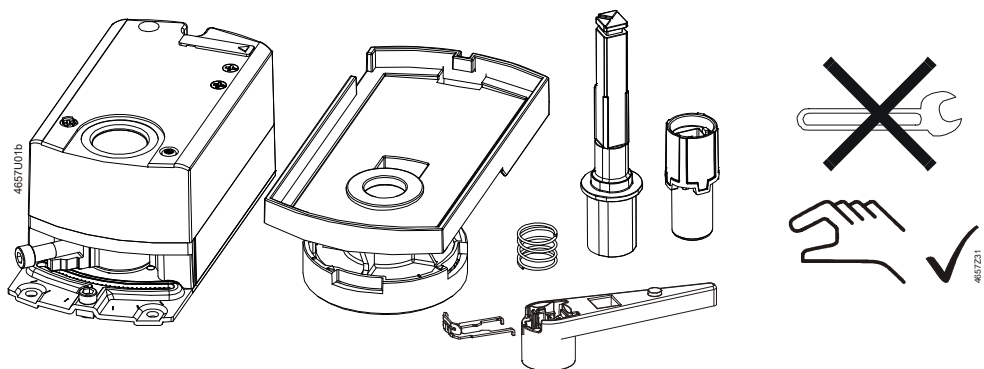

B **de** Hinweise / Warnungen
en Notes / Warnings
fr Indications / Mise en garde
sv Hänvisningar / Varningar

nl Aanwijzingen / Waarschuwingen
it Messa in servizio / Indicazioni
fi Huomauksia / Varoituksia
es Indicaciones / Consejos

da Bemærkninger / Advarsler
zh 提示 / 警告

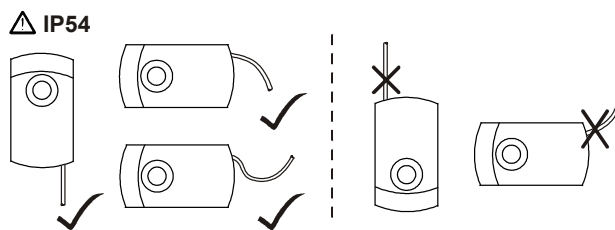
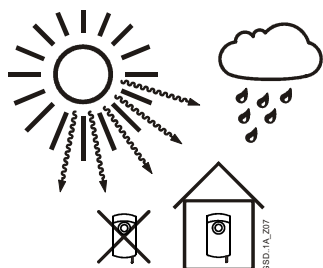
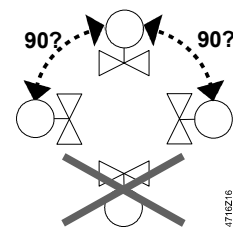
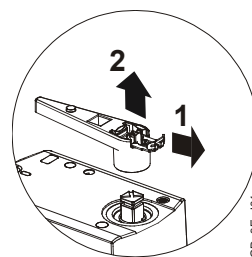
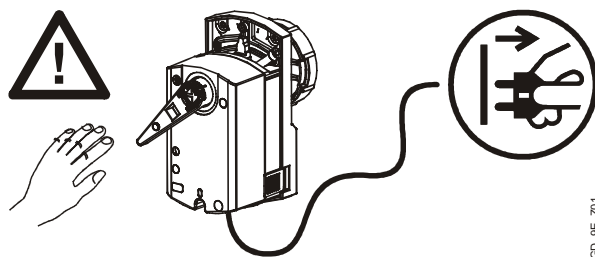

GLB16..9E

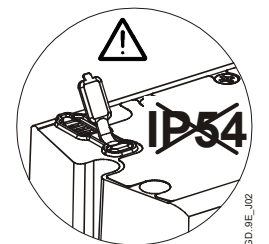

C**de** Montage auf Kugelhahn**en** Ball valve Mounting**fr** Montage sur vanne à boisseau sphérique**sv** Montera ställdonet på kulventilen**nl** Montage op de Kogelafsluiter**it** Montaggio sull'valvoia a sfera**fi** Asennus palloventtiiliin**es** Montaje sobre el válvula de bola**da** Montering på kulventil**zh** 裝配在球閥閥體上**1** GLB..9E.. + V..61.32.. – V..61.50.. ➔ 2 ... 6.4

GLB..9E.. + V..60.. ➔ 7 ... 9.4

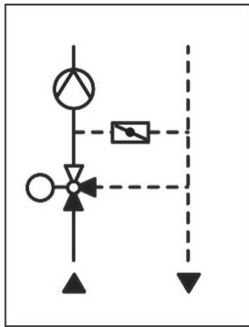
2**NC**

Normally Closed

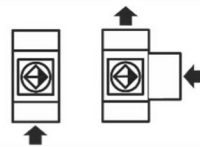
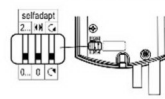
only for
GLB161.9E..➔ **3****NO**

Normally Open

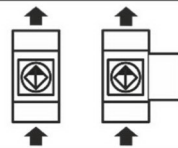
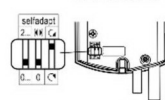
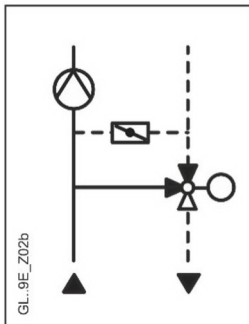
only for
GLB161.9E..➔ **4****NC**

Normally Closed

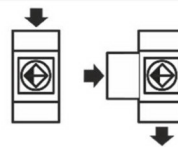
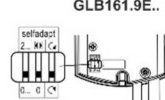
only for
GLB161.9E..➔ **5****NO**

Normally Open

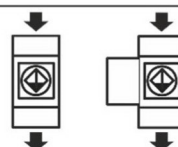
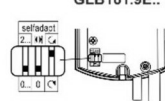
only for
GLB161.9E..➔ **6**

GL..9E_ZU2b

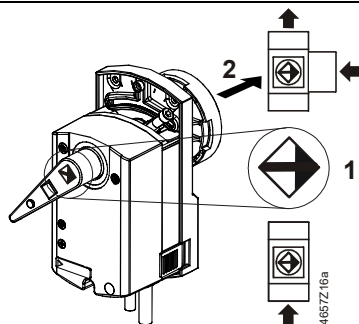
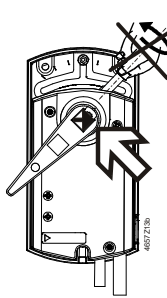
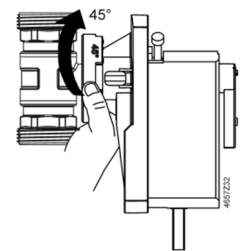
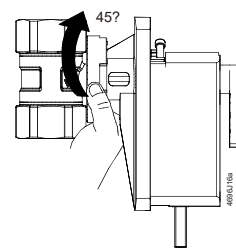
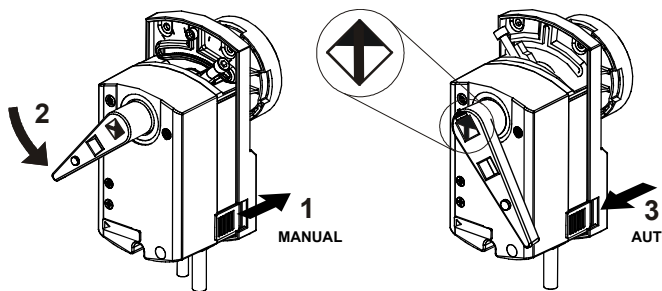
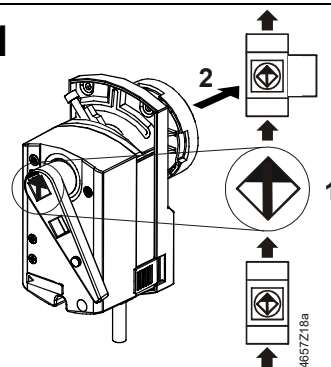
3**3.1****3.2****4****4.1**

4.2

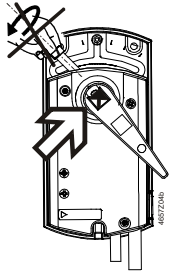

4.3

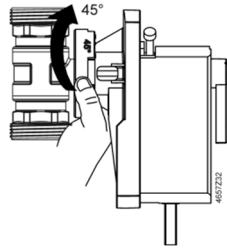
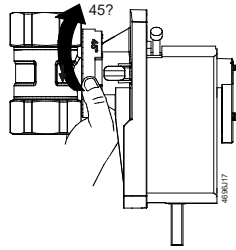

5

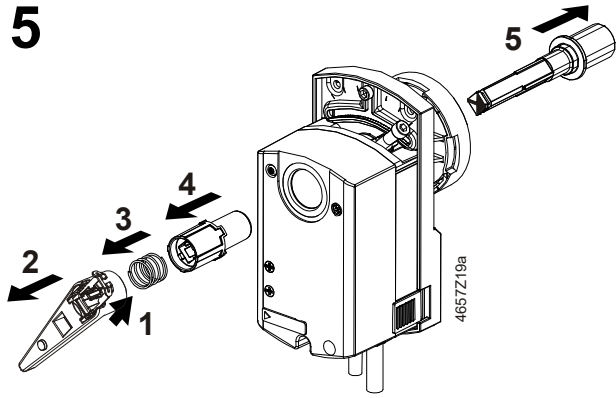

5.1

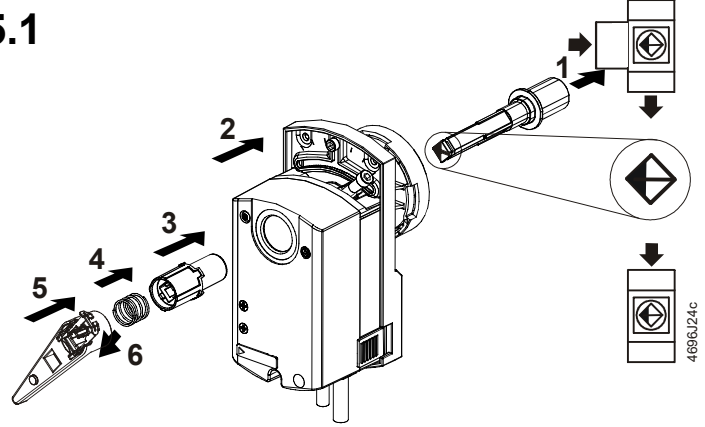

5.2

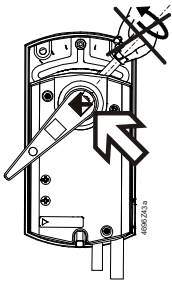

5.3

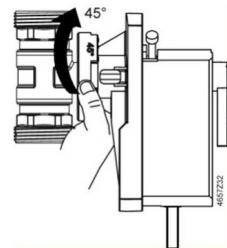
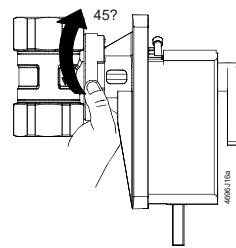

6

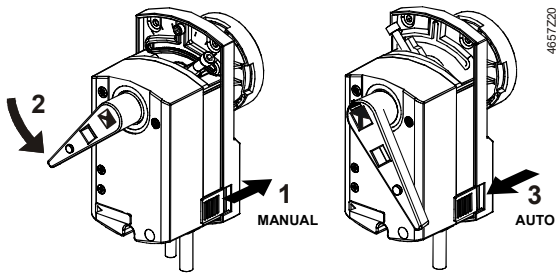

6.1

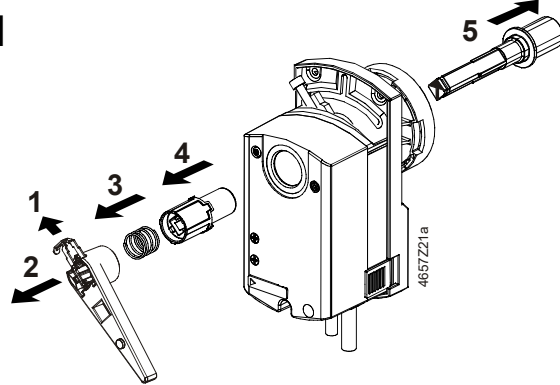

6.2

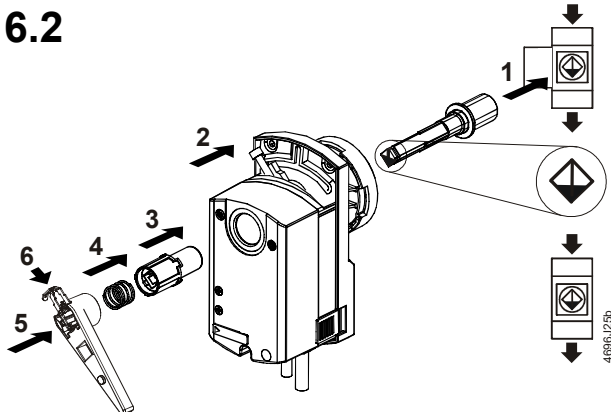



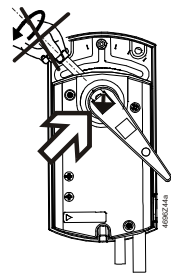



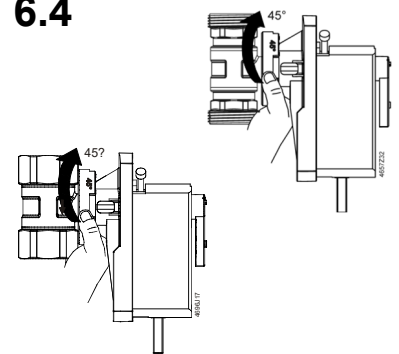



6.3

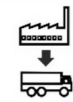

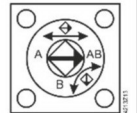
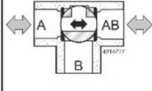
6.4

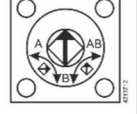
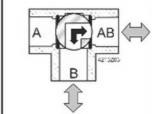

7 GLB..9E.. CW   selfadapt 2... 0... 0... 0... only for GLB161.9E..				GLB..9E.. + V..60..
	VA..60..	—		 8
	VB..60..T			 8
	VBI60..L			 9

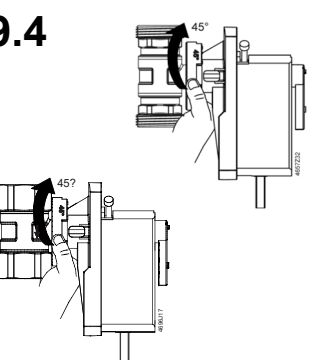
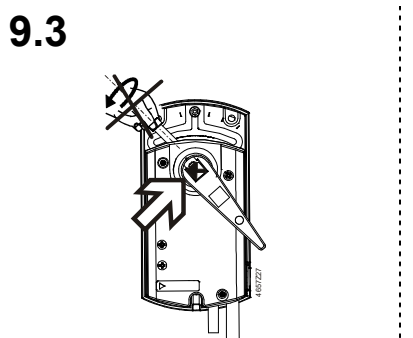
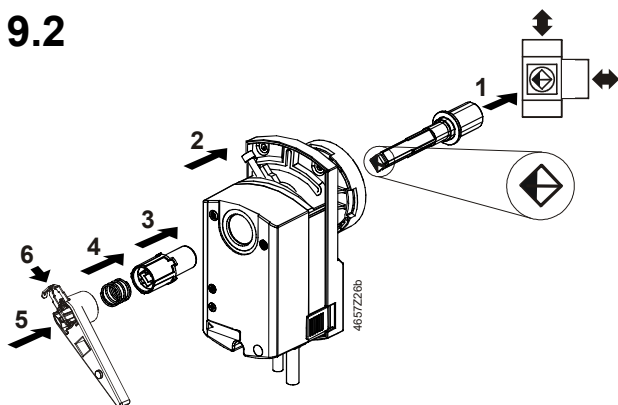
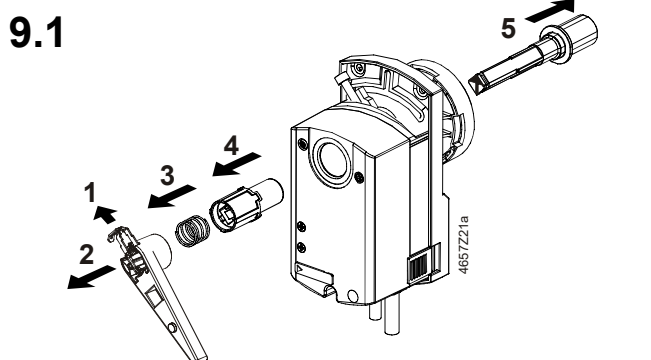
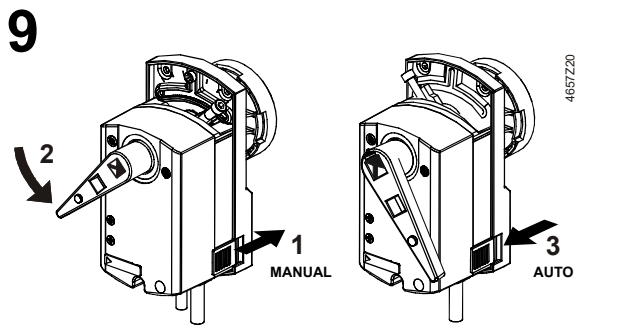
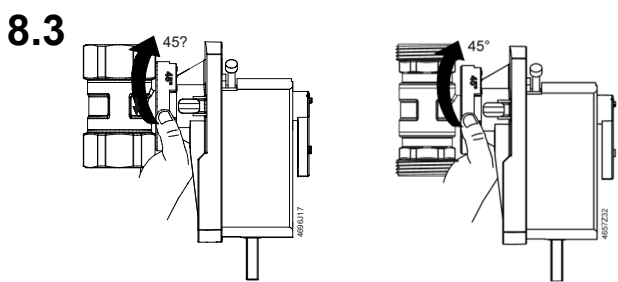
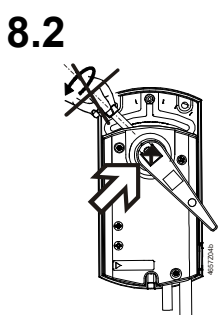
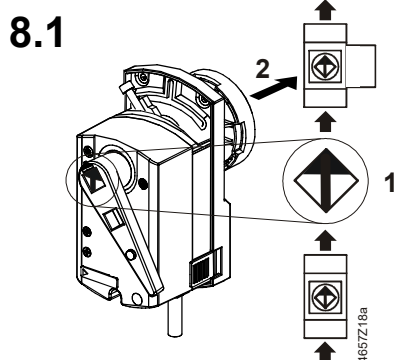
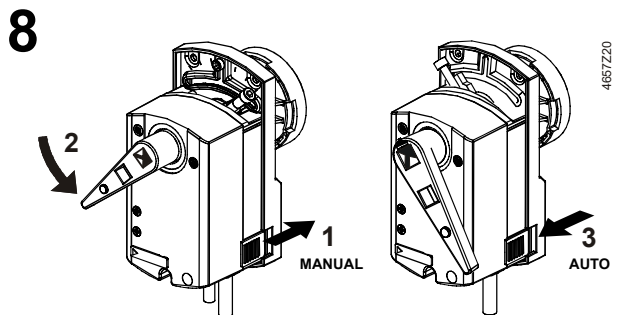

D

de Massbild
 en Dimensions
 fr Encombrement
 sv Måttuppgift

nl Maatschets
 it Ingombri
 fi Mittapiirros
 es Dimensiones

da Målskitse
 zh 尺寸

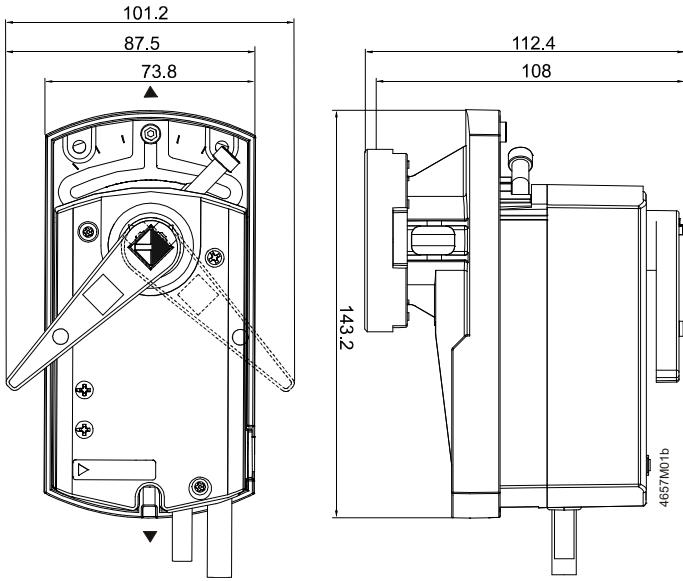

Minimum clearance from ceiling or wall for mounting, connection, operation, maintenance etc.

- ▶ = > 100 mm
- ▶▶ = > 200 mm

Masse in mm
 Dimensions in mm
 Dimensions en mm

Mått i mm
 Afmetingen in mm
 Dimensioni in mm

Mitat mm
 Dimensiones en mm
 Mål i mm

尺寸单位 mm

GLB161.9E/MO Externer Modbus Konverter

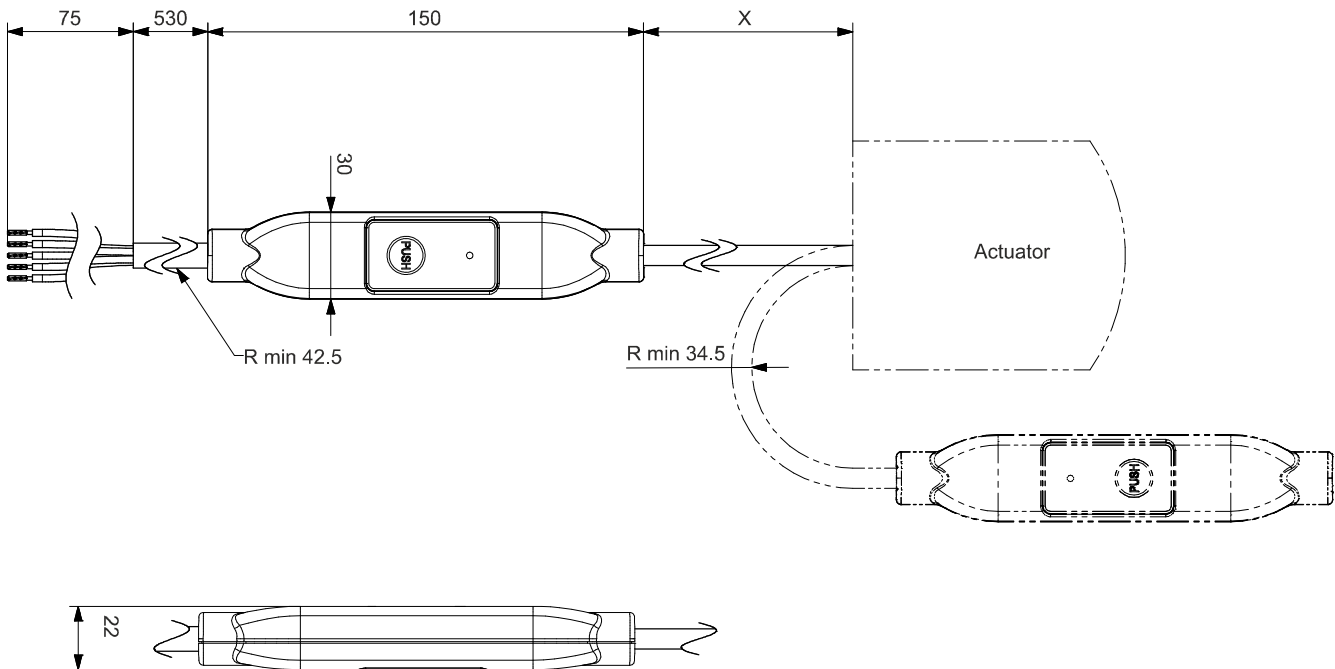

GLB141.9E

AC 24 V ~ / DC 24...48 V ~

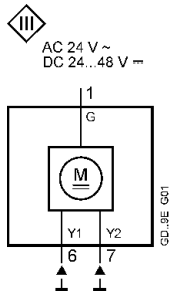

SPST

Auf / ZU ON / OFF
ON / OFF AUKI/KIINNI
MARCHE/ARRET CON./DESC.
PÄ/AV TIL/FRA
AAN/UIT 开/关

AC 24 V ~ / DC 24...48 V ~

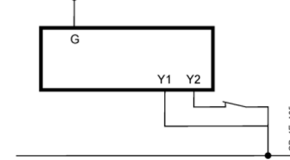

AC 24 V ~ / DC 24...48 V ~

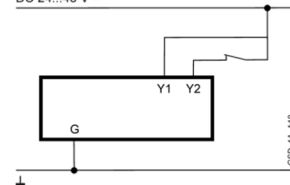

SPDT

Auf / ZU ON / OFF
ON / OFF AUKI/KIINNI
MARCHE/ARRET CON./DESC.
PÄ/AV TIL/FRA
AAN/UIT 开/关

AC 24 V ~ / DC 24...48 V ~

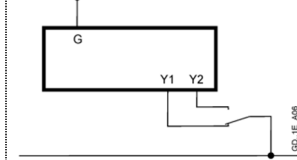

AC 24 V ~ / DC 24...48 V ~

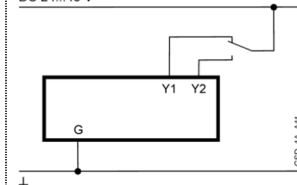

3P

3-Punkt Komando a 3 punti
3P Kolmpisteohjaus
Comm. 3 p. Control a 3 p.
Treläges styrning Trepunksstyrning
Driepuntsbesturing 三位控制

AC 24 V ~ / DC 24...48 V ~

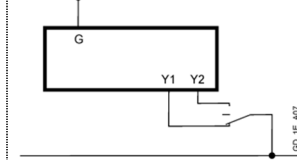

AC 24 V ~ / DC 24...48 V ~

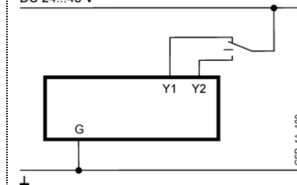

GLB341.9E

AC 100...240 V ~

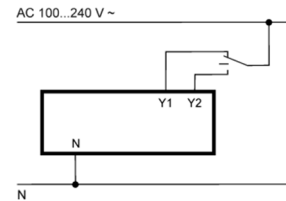
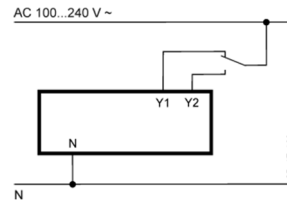
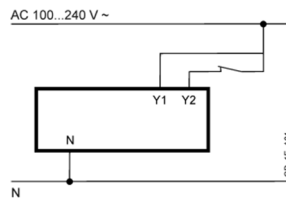
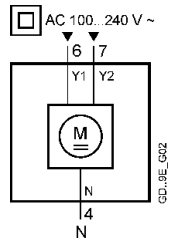

GLB161.9E

AC 24 V ~ / DC 24...48 V ~

Stetigsteuerung
DC 0/2...10 V
Modulating control
DC 0/2...10 V
Commande progressif
DC 0/2...10 V
Kommandu progressif
DC 0/2...10 V DC
Modulere besturing
DC 0/2...10 V DC
Comando analogico
DC 0/2...10 V c.c.
Moduloiva ohjaus
DC 0/2...10 V DC
Control continuo
DC 0/2...10 V CC
Kontinuierlig styring
DC 0/2...10 V
连续量控制

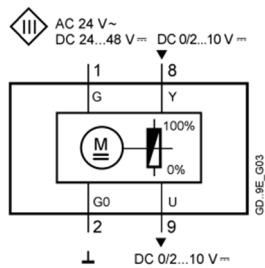

AC 24 V ~ / DC 24...48 V ~

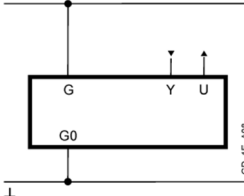

GLB161.9E/MO

AC 24 V ~ / DC 24 V ~

Stetigsteuerung Modbus
Modulating control Modbus
Commande progressif Modbus
Kommandu progressif Modbus
Modulere besturing Modbus
Comando analogico Modbus.
Moduloiva ohjaus Modbus
Control continuo Modbus
Kontinuierlig styring Modbus
连续量控制

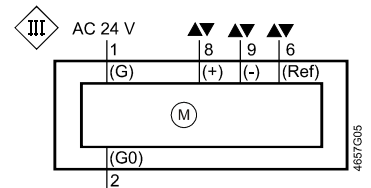

de

Kabelbezeichnungen

Anschluss	Kabel				Bedeutung
	Code	Nr.	Farbe	Abkürzung	
Antriebe AC 24 V ~ DC 24...48 V ==	G	1	rot	RD	System Potential AC 24 V ~ / DC 24...48 V ==
	G0	2	schwarz	BK	Systemnull
	Y1	6	violett	VT	Stellsignal AC/DC 0 V "Uhrzeigersinn" (GLB141.9E)
	Y2	7	orange	OG	Stellsignal AC/DC 0 V "Gegenuhrzeigersinn" (GLB141.9E)
	Y	8	grau	GY	Signaleingang (GLB161.9E)
	U	9	rosa	PK	Signal Ausgang (GLB161.9E)
Antriebe AC 100...240 V ~	N	4	hellblau	BU	Nullleiter
	Y1	6	schwarz	BK	Stellsignal AC 100...240 V ~ "Uhrzeigersinn" (GLB341.9E)
	Y2	7	weiss	WH	Stellsignal AC 100...240 V ~ "Gegenuhrzeigersinn" (GLB341.9E)
Modbus AC 24 V ~ DC 24 V =	Ref	6	violett	VT	Reference
	+	8	grau	GY	Modbus +
	-	9	rosa	PK	Modbus -

en

Wire designations

Connection	Cable				Meaning
	Code	No.	Color	Abbreviation	
AC 24 V ~ DC 24...48 V == Actuators	G	1	red	RD	System potential AC 24 V ~ / DC 24...48 V ==
	G0	2	black	BK	System neutral
	Y1	6	purple	VT	Positioning signal AC/DC 0 V "clockwise" (GLB141.9E)
	Y2	7	orange	OG	Positioning signal AC/DC 0 V "anticlockwise" (GLB141.9E)
	Y	8	grey	GY	Signal-in (GLB161.9E)
	U	9	pink	PK	Signal-out (GLB161.9E)
AC 100...240 V ~ Actuators	N	4	light blue	BU	Neutral
	Y1	6	black	BK	Positioning signal AC 100...240 V ~ "clockwise" (GLB341.9E)
	Y2	7	white	WH	Positioning signal AC 100...240 V ~ "anticlockwise" (GLB341.9E)
Modbus AC 24 V ~ DC 24 V =	Ref	6	purple	VT	Reference
	+	8	gray	GY	Modbus +
	-	9	pink	PK	Modbus -

fr

Désignation des câbles

Câbles de raccordement	Câble				Signification
	Code	No.	Couleurs	Abbreviation	
servo-moteurs AC 24 V ~ DC 24...48 V ==	G	1	rouge	RD	potentiel du système AC 24 V ~ / DC 24...48 V ==
	G0	2	noir	BK	zéro du système
	Y1	6	violet	VT	signal de commande AC/DC 0 V "sens horaire" (GLB141.9E)
	Y2	7	orange	OG	signal de comm. AC/DC 0 V "sens anti-horaire" (GLB141.9E)
	Y	8	gris	GY	entrée signal (GLB161.9E)
	U	9	rose	PK	sortie signal (GLB161.9E)
servo-moteurs AC 100...240 V ~	N	4	bleu clair	BU	neutre
	Y1	6	noir	BK	Signal de commande AC 100...240 V ~ "sens horaire" (GLB341.9E)
	Y2	7	blanc	WH	Signal de commande AC 100...240 V ~ "sens anti-horaire" (GLB341.9E)
Modbus AC 24 V ~ DC 24 V =	Ref	6	violet	VT	Reference
	+	8	gris	GY	Modbus +
	-	9	rose	PK	Modbus -

zh

电缆说明

连接	线缆				注解
	端子号	端子	颜色	缩写	
AC 24 V ~ DC 24...48 V == 驱动器	G	1	红色	RD	供电类型为 AC 24 V ~ / DC 24...48 V ==
	G0	2	黑色	BK	中性
	Y1	6	紫色	VT	驱动器控制信号 AC/DC 0 V "顺时针旋转" (GLB141.9E)
	Y2	7	橙色	OG	驱动器控制信号 AC/DC 0 V "逆时针旋转" (GLB141.9E)
	Y	8	灰色	GY	信号输入 (GLB161.9E)
	U	9	粉色	PK	信号输出 (GLB161.9E)
AC 100...240 V ~ 驱动器	N	4	淡蓝色	BU	中性
	Y1	6	黑色	BK	驱动器控制信号 AC 100...240 V ~ "顺时针旋转" (GLB341.9E)
	Y2	7	白色	WH	驱动器控制信号 AC 100...240 V ~ "逆时针旋转" (GLB341.9E)
Modbus AC 24 V ~ DC 24 V =	Ref	6	紫色	VT	Reference
	+	8	灰色	GY	Modbus +
	-	9	粉色	PK	Modbus -